

MODERN LUXURY

Meets Coastal Charm

on the **INTRACOASTAL WATERWAY**



DOLPHIN
SHORES

LUXURY CONDO LIVING
near Holden Beach

Standout Features



- Waterfront on the Intracoastal Waterway
- Gated
- Community Pier
- Day Dock with Slips
- Kayak/Paddleboat Launch
- Olympic Sized Pool
- Clubhouse
- Covered Parking
- Elevators in Heated & Cooled Corridors
- ADA Compliant

Waterfront Amenities



Developed, designed and built by Stokley Development Corporation • DolphinShoresNC.com



2256 Dolphin Shores Drive

12 Units in Building B

SUPPLY, NC

3 Bedrooms

3 Baths

1,675 Square Feet

- Luxury Finishes
- Private Balconies
- ADA Compliant

Construction to start June 2019
Estimated date of completion: Fall 2019

Developed, designed and built by Stokley Development Corporation • DolphinShoresNC.com

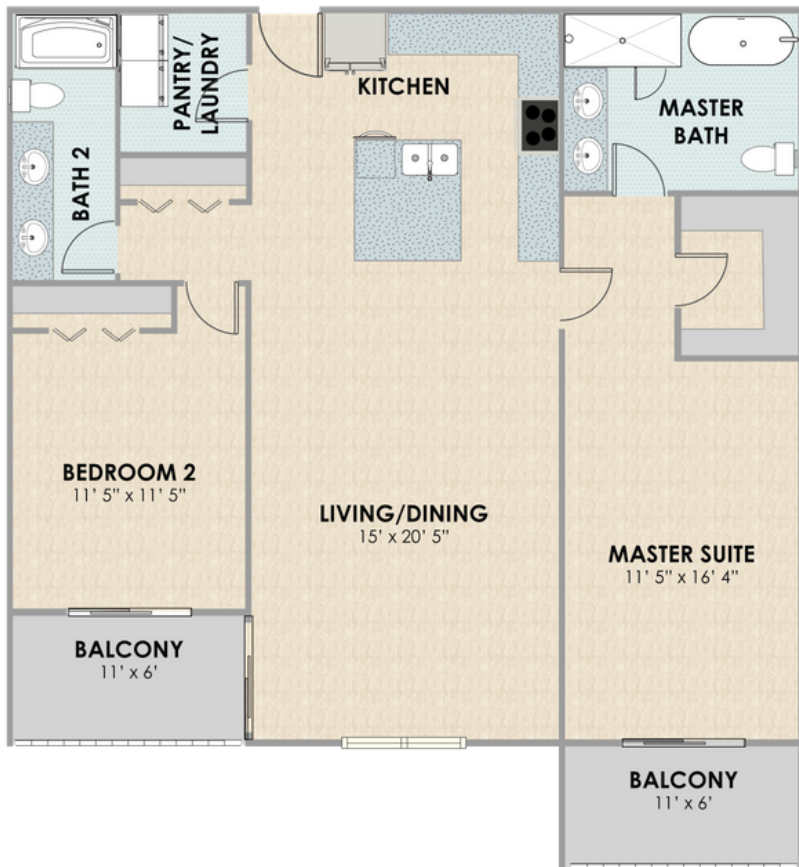

2256 Dolphin Shores Drive

12 Units in Building B

SUPPLY, NC

2 Bedrooms

2 Baths

1,356 Square Feet

- Luxury Finishes
- Private Balconies
- ADA Compliant

Construction to start June 2019
Estimated date of completion: Fall 2019

Interiors



FLOORING

Luxury Vinyl
Plank: NICOLA
OAK

Glazed Porcelain:
DANYA COVE

COUNTERTOPS

Premium quartz:
DESERT SILVER

BACKSPLASH

3 x 6 Subway:
WHITE

Cumulus Cotton

WALL COLOR
CUMULUS COTTON

KITCHEN
FAUCET

Pulls - Cabinet
Drawers & Doors

KITCHEN & BATH
CABINETS
HORIZON

OPTION

1

Selections are subject to change on availability and developers request.

Interiors



FLOORING
Luxury Vinyl Plank:
CABIN OAK



Glazed Porcelain:
WHITE



Mocha Cream



WALL COLOR
Benjamin Moore:
MOCHA CREAM

COUNTERTOPS

Premium quartz:
BLANCO MAPLE

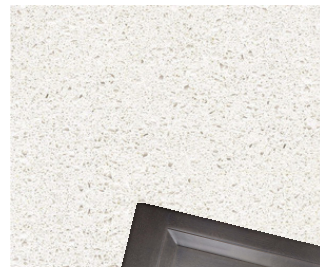

BACKSPLASH

3 x 6 Herringbone:
WHITE

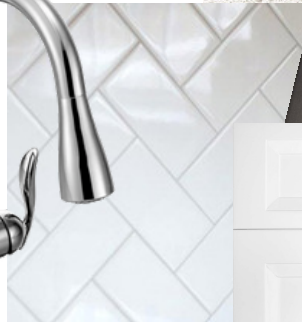

**KITCHEN
FAUCET**



**Pulls - Cabinet
Drawers & Doors**



**KITCHEN & BATH
CABINETS**

ONYX &:
GALAXY FROST



Selections are subject to change on availability and developers request.

Interiors



FLOORING

Luxury Vinyl Plank:
EDINBURGH OAK



Glazed Porcelain:
DANYA COVE



COUNTERTOPS

Premium quartz:
LUSSO



BACKSPLASH

3 x 6 Subway:
WHITE

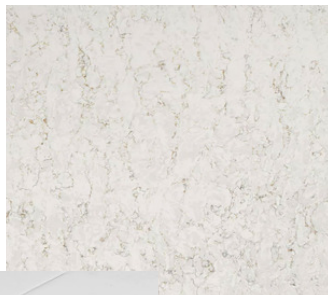

White Sand

WALL COLOR

Benjamin Moore:
WHITE SAND



KITCHEN FAUCET



Pulls - Cabinet
Drawers & Doors



KITCHEN & BATH CABINETS

WELLINGTON
IVORY



OPTION

3

Selections are subject to change on availability and developers request.

Interiors



FLOORING
Luxury Vinyl
Plank: NICOLA
OAK

Glazed Porcelain:
WHITE

Decorator's White

WALL COLOR
DECORATOR'S WHITE

OPTION

4

COUNTERTOPS
Premium quartz:
ETERNAL SERENA

BACKSPLASH
3 x 6 Subway:
LIGHT GRAY



**KITCHEN
FAUCET**

**Pulls- Cabinet
Drawers & Doors**

**KITCHEN & BATH
CABINETS**
GALAXY FROST

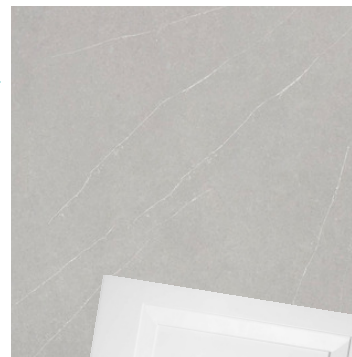

Selections are subject to change on availability and developers request.

Appliances



Selections are subject to change on availability and developers request.

Universal Design



The two and three bedroom plans are thoughtfully designed to be accessible to everyone, addressing the needs of people aging in place and can also be customized for people living with disabilities.

- Open floorplan
- Wider doorways
- Lever door handles
- Comfort height elongated toilet
- Reinforced walls with grab bars in bathroom
- Roll in tile shower
- Walk-In tub
- Multi height kitchen and bathroom counters
- Lowered light switches

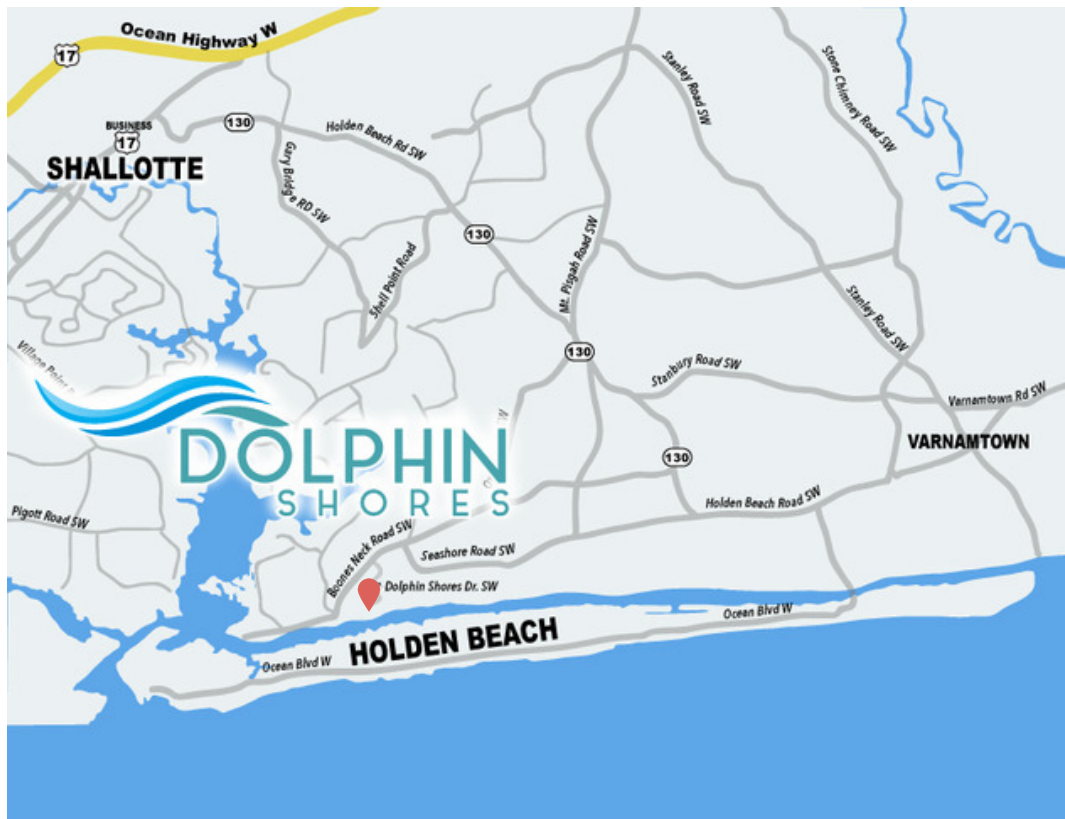

Situated on the mainland side of Holden Beach on the Intracoastal Waterway, Dolphin Shores offers residents the best of coastal living less than 10 minutes from the sands of the Atlantic Ocean. Tucked between Myrtle Beach, SC and Wilmington, NC Dolphin Shores overlooks Holden Beach, rated as one of the best family beaches in the country by National Geographic Traveler Magazine.

Whether you are a beach lover, golfer, boater, fisherman or all of the above, living your dream coastal lifestyle has never been easier or more convenient.

- WILMINGTON INTERNATIONAL AIRPORT: 40 Miles
- MYRTLE BEACH INTERNATIONAL AIRPORT: 55 Miles

JESS
WAINWRIGHT

REALTOR® & MARKETER

910-518-5377

mobile/text



NIKI
TODD

REALTOR® & MARKETER

910-274-2648

mobile/text



Call Niki or Jess for a tour of the waterfront amenities in Dolphin Shores.



Sales + Amenity Center: 2284 Dolphin Shores Dr SW • Supply, NC 28462 • 910-518-5377